



# S350

SLIDING SYSTEM WITH THERMAL BREAK

Insulated sliding system, in simple straight lines, a completely new and modern concept most suitable for replacements.

- Insulation  $U_f$  from 2,8  $W/m^2K$ , top in its category, contributing significantly in the buildings overall performance
- Chambered and reinforced sashes for improved sturdiness, with 35 mm width and weight up to 120 Kg
- Additional and a narrower sash (height 47 mm instead of 85 mm) for even less visible aluminium and more light
- All typologies and compatible with various mechanisms for additional flexibility to fabricators
- Special sash with anti-distortion polyamides to avoid possible malfunctions due to high temperature differences

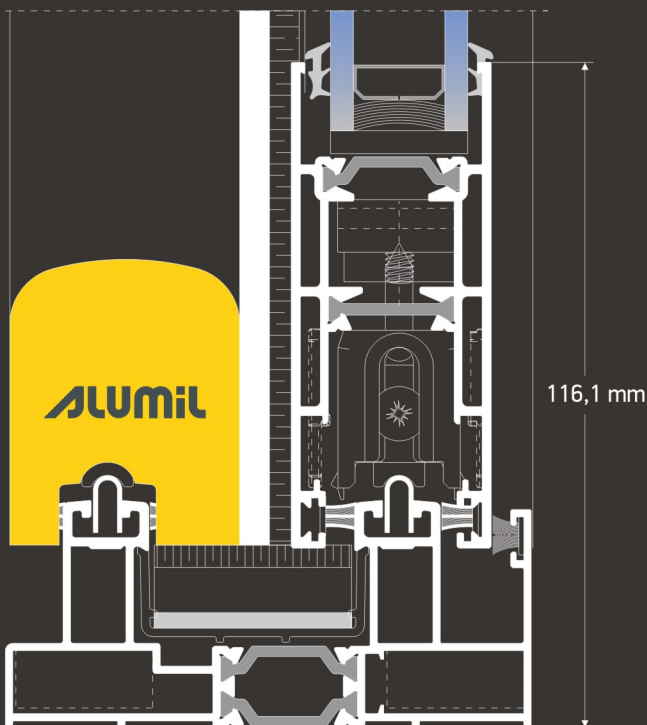

# S350

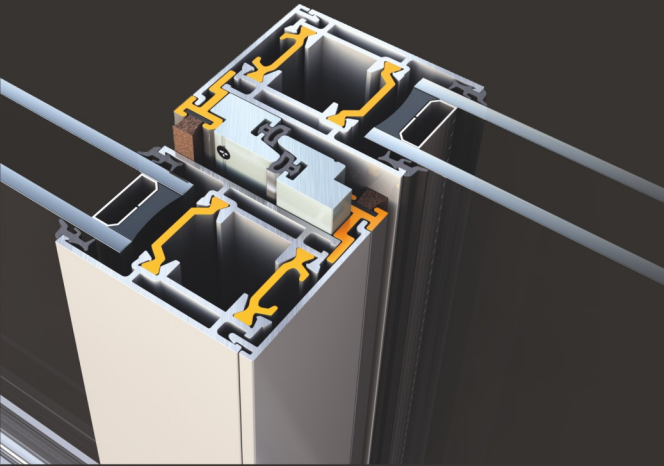

## TECHNICAL CHARACTERISTICS

Visible aluminium face width	116 mm
Frame height	39,6 mm
Frame width	92 mm
Sash height	47/85 mm
Sash width	35 mm
Interlocking profile width	47/85 mm
Sash weight	Up to 120 kg
Glazing	25 mm
Insulation	Polyamides 24 mm width, PVC

## TYOLOGIES

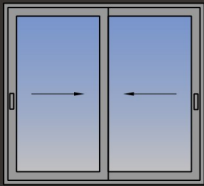

Double horizontal sliding sash

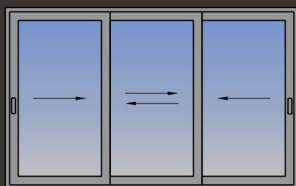

Triple horizontal sliding sash

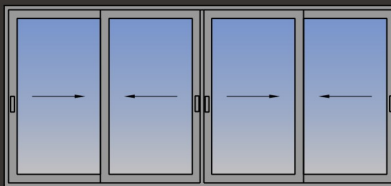

Four horizontal sliding sashes meeting stile

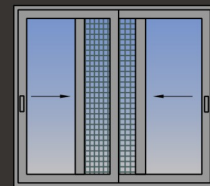

Double horizontal sliding sash with fly-screen

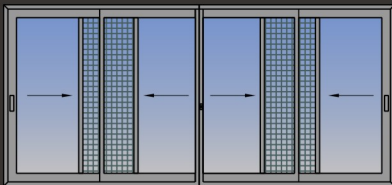

Four horizontal sliding sashes meeting stile with fly-screen

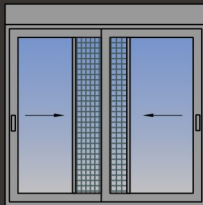

Double horizontal sliding sash with fly-screen & rolling shutter

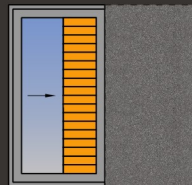

Single horizontal sliding pocket sash with shutter

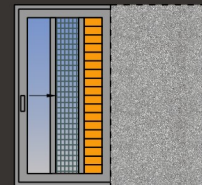

Single horizontal sliding pocket sash with fly-screen & shutter

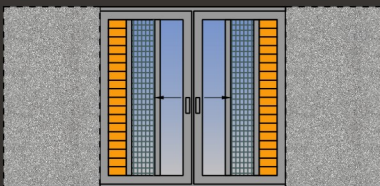

Double horizontal sliding pocket sash with fly-screen & shutter

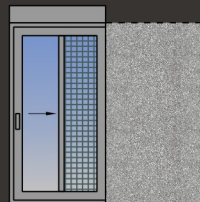

Single horizontal sliding pocket sash with fly-screen & rolling shutter

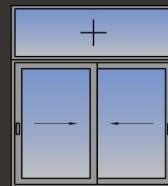

Double horizontal sliding sash with fanlight

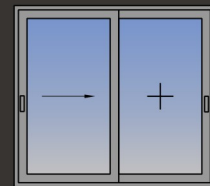

Single horizontal sliding sash with fixed light

## CERTIFICATES

	Air permeability EN 1026, EN12207	CLASS 3
	Watertightness EN 1027, EN 12208	CLASS 6A
	Resistance to wind load EN 12210, EN 12211	CLASS C2/B3
	Thermal Insulation EN 10077	U <sub>f</sub> from 2,8 to 4,8 W/m <sup>2</sup> K
	Sound reduction EN 14351, EN 717	R <sub>w</sub> (C;Ctr) = 28 (-1;-1) dB



**ALUMIL SA**  
KILKIS INDUSTRIAL AREA  
GR 61 100, KILKIS  
TEL: +30 23410 79300  
FAX: +30 23410 71988  
[www.alumil.com](http://www.alumil.com)